

SPEC PACK BATHROOM COLLECTION

SPEC SHEET



NUGLEAM 900 THIN TOP VANITY

PRODUCT CODE:

77072

FEATURES:

- / 15mm vitreous china top with overflow, 1TH
- / High gloss white cabinet made from moisture resistant E1 HMR board
- / Can be wall mounted
- / Finger pull doors & soft close drawers
- / Adjustable shelf

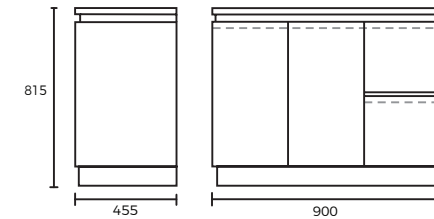

OVERALL DIMENSIONS:

900 W x 815 H x 455mm D

WARRANTY:

5 year replacement only

1 year replacement warranty on plug and waste

Disclaimer: All measurement are in millimetres and are solely for reference purposes. Colours have been reproduced with as much accuracy as possible. Any changes resulting from technical advance of design or colour may be made without prior notice. Tapware, accessories and appliances are for illustration purposes only. Further information on warranties is available at www.everhard.com.au

SPEC PACK BATHROOM COLLECTION

PRODUCT DRAWING

