

**Product Name:**  
3000L Septic Tank

**EI Code:**  
87001 - without partition  
87003- with partition

**Dimensions:**  
1875 H x 1880 D

**Weight:**  
125kg - without partition  
133kg - with partition

**Material:**  
PP

**Warranty:**  
15 Years

**Additional Information:**

It is a **legal requirement** that all domestic septic tanks over 2050L in NSW & VIC be installed with a partition. Larger capacity collection wells available using multiple tanks.



Product Code	Description	Weight kg	A Overall Height	B Liquid Level	C Tank Rim to Invert of Outlet	D Under Roof to Invert of Outlet	E Maximum Cover to Inlet Pipe	F Diameter at Top	G Maximum Cover to Outlet Pipe
87001	3000L Septic Tank with no partition	125	1875	1385	225	475	325	1880	375
87003	3000L Septic Tank with partition	133	1875	1385	225	475	325	1880	375

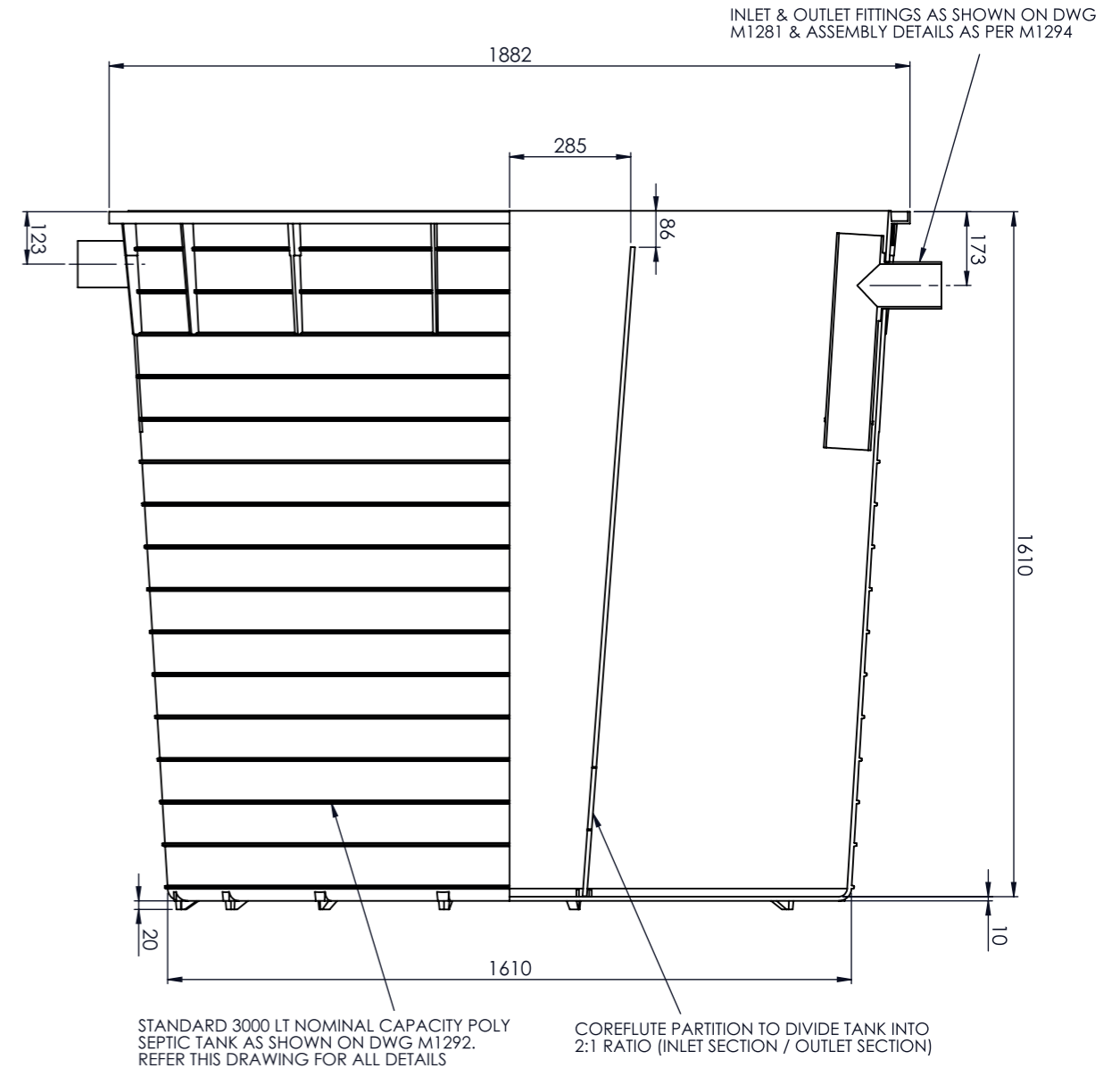

\*Drawing does not include the lid of the septic tank

Disclaimer: All measurements are in millimetres and are subject to change without any prior notice. It is advised for this product to be installed by a professional contractor to ensure installation is correct. Further information is available at [www.everhard.com.au](http://www.everhard.com.au)