

SURFACE WATER DRAINAGE

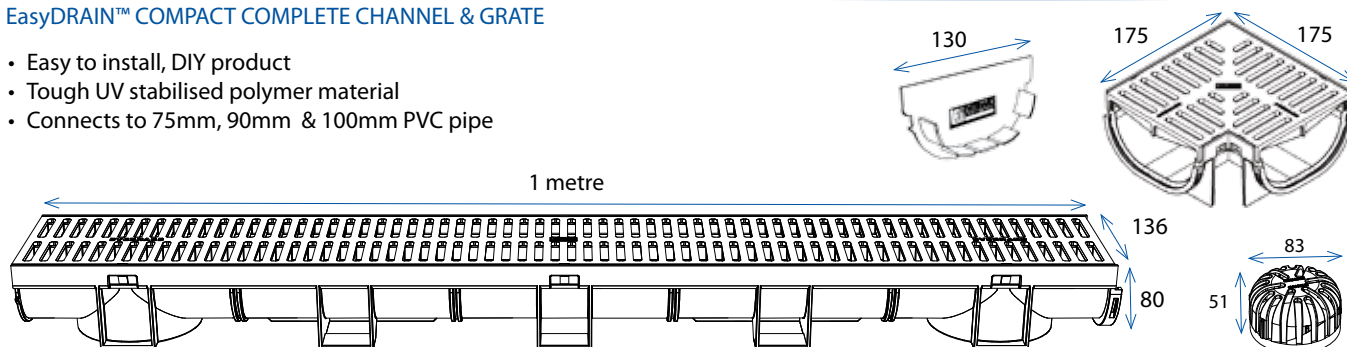

EasyDRAIN™ COMPACT COMPLETE CHANNEL & GRATE

- Easy to install, DIY product
- Tough UV stabilised polymer material
- Connects to 75mm, 90mm & 100mm PVC pipe



EasyDRAIN™ COMPACT COMPLETE CHANNEL & GRATE

EasyDRAIN™ Compact Channel c/w Heel Friendly Polymer Grate Black		EasyDRAIN™ Compact Corner c/w Heel Friendly Polymer Grate Black		EasyDRAIN™ Compact End Cap Black	
PRODUCT CODE		PRODUCT CODE		PRODUCT CODE	
83500		83600		83700	
WEIGHT (Kg)		WEIGHT (Kg)		WEIGHT (Kg)	
2.0	9 314319 034702	0.5	9 314319 034740	0.1	9 314319 034788
EasyDRAIN™ Compact Channel c/w Pressed Galvanised Steel Grate		EasyDRAIN™ Compact Corner c/w Pressed Galvanised Steel Grate		EasyDRAIN™ Leaf Dome	
PRODUCT CODE		PRODUCT CODE		PRODUCT CODE	
83501		83601		84040	
WEIGHT (Kg)		WEIGHT (Kg)		WEIGHT (Kg)	
2.5	9 314319 034733	0.7	9 314319 034771	0.1	9 314319 034856

Female ends

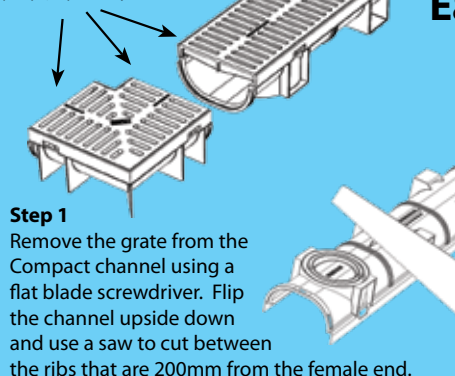

EasyDRAIN™ Compact - No need for a connector!

Step 2
Trim the ends with a Stanley knife so that the ribs are neat and all excess plastic is removed.

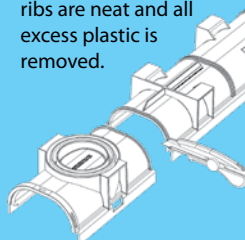

Step 3
Rotate the 200mm section so that the female end now matches up with the rib at the new end of the channel.
Now you have a 1m channel with two male ends.

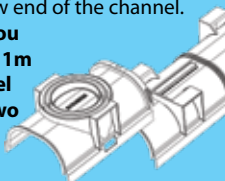

Step 4
Flip the channel to the right way up and clip the grate back into position. Now the channel and grate can be connected to the corner components on each end.

